

INSTALLATION GUIDELINES

Regupol® 4515 Multi is a tough, resilient acoustic underlayment manufactured from PUR foam/cork and is specifically designed to attenuate impact sound on all types of subfloor.

Before you lay Regupol® 4515 Multi

1. Prepare the concrete floor. It is important that the concrete floor is dry (under 75% RH), clean (free of dirt and concrete dust) and flat (no more than 2mm undulations). If the floor is uneven, it must be made level.
2. Please ensure each roll of **Regupol® 4515 Multi** is completely unrolled, turned over and left in the area to which it is to be applied for a minimum of 6 hours or ideally overnight prior to cutting and installing.

Laying the Regupol® 4515 Multi

1. Bond **Regupol® 4515 Multi** to the base floor making sure the print, "REGUPOL® – DO NOT REMOVE" is shown at all times. The **Regupol® 4515 Multi** should be bonded to the subfloor using one of our recommended adhesives – please contact CMS Danskin for a list or alternatively please refer to the website www.cmsdanskin.co.uk. Please ensure the adhesive guidelines are followed at all times.
2. Lay the **Regupol® 4515 Multi** into the adhesive and press from the centre outwards to exclude air and ensure overall contact with the adhesive.
3. Roll the **Regupol® 4515 Multi** with a 68kg flooring roller, from end to end and side to side to ensure overall contact.
4. Please leave a minimum gap of 3mm around the entire perimeter to allow for potential expansion and contraction. Do not butt the **Regupol® 4515 Multi** against the skirting boards.
5. Use a craft knife and straight edge for cutting to size and please ensure that all edges are butt jointed.
6. After 30 minutes, when the floor has been completely covered, roll once again to ensure contact is maintained.
7. Please do not apply loads or move furniture on the **Regupol® 4515 Multi** until the adhesive has fully set. Please refer to the adhesive manufacturer's installation guidelines for curing times.

Laying the Laminate Floor

1. Lay the laminate floor panels in accordance with the manufacturer's instructions, which should be supplied with each pack.
2. Unless advised to do so by the manufacturer, DO NOT bond the laminate floor to the **Regupol® 4515 Multi** acoustic underlay. To be effective the laminate floor must 'float'.
3. A minimum gap of 3mm must be left between the laminate floor panels and the skirting boards and/or wall.

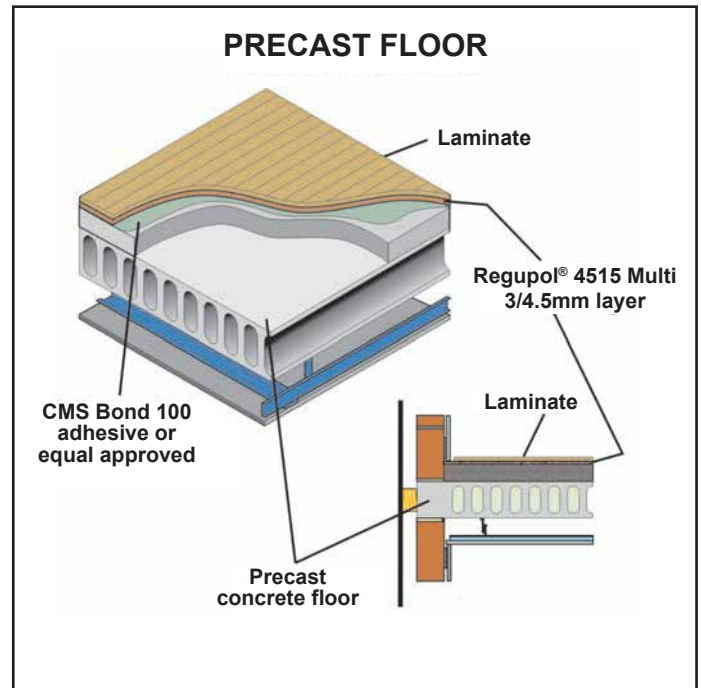

Diagrams are for example purposes only

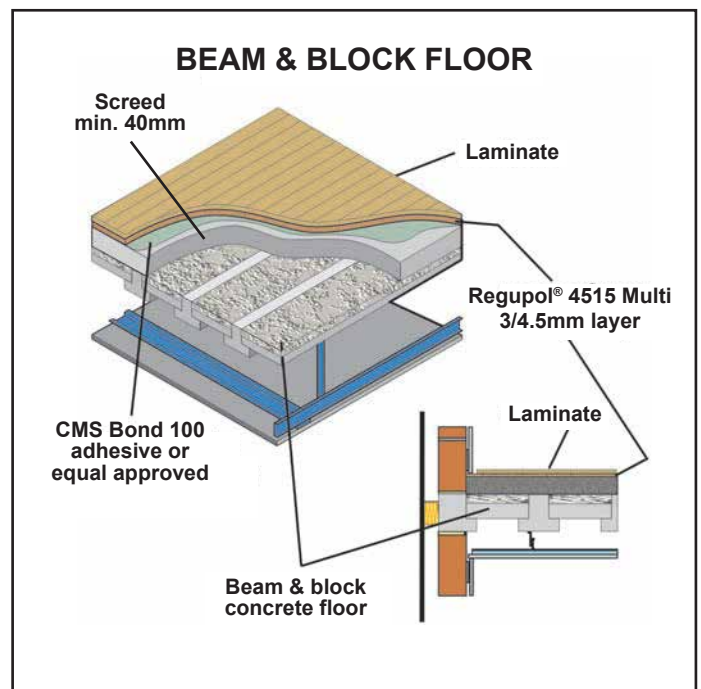

Diagrams are for example purposes only

continued from the front

NB

1. These instructions are for guidance only: the laminate floor should be laid in accordance with the manufacturer's instructions.
2. The recognized technical rules of the industry, and the code of practice requirements of BS8203:2001 "Installation of Resilient Floor Coverings" are to be observed.
3. Regupol® Acoustic Underlayments can be easily installed providing BS 8203:2001 and our installation guidelines are observed.

Installation Service

In addition to supply of this product, CMS Danskin Acoustics offers a competitively-priced installation service anywhere in the UK. Use of our service ensures that installation is performed to the highest standards by tradesmen fully experienced in the specialist skills of fitting acoustic materials correctly. For further details contact our technical team on 01925 577711.

Storage

Regupol® 4515 Multi must be stored indoors. At no time must the **Regupol® 4515 Multi** be exposed to the elements of the weather.

Regupol® 4515 Multi must always be kept dry, otherwise moisture will build up in the material and will subsequently make bonding to the subfloor very difficult. Moisture will also cause the material to curl and ripple at the edges once unrolled.

It is recommended that the polythene packaging be removed in the area where it shall be applied.

Important Notes

1. **Regupol® 4515 Multi** consists of PUR foam/cork and no rubber crumb. Should an alternative product to **Regupol® 4515 Multi** with rubber crumb be supplied, please notify CMS Danskin immediately. CMS Danskin Acoustics Limited accepts no responsibility for the installation of any materials offered as an alternative to **Regupol® 4515 Multi**.
2. **Not to be installed on timber based floor constructions.**
3. Health and safety data sheets are available on request.



BSPlus

To access the CMS Danskin website for further product information please scan the QR code

IMPORTANT: Directions for use are given for guidance only and are not intended to form part of any contract. They should be varied or adapted to suit your particular materials or conditions of use. Goods supplied by the company are made to approved standards from the highest quality raw materials but no warranty or guarantee is given as to their suitability for any particular purpose or application, and no liability is accepted for any loss or damage arising directly or indirectly from the use of the Company's products irrespective of any information given to us as to intended use of such products. It is therefore recommended that prospective users should test a sample of this product under their own conditions to satisfy themselves that the product is suitable for the purpose intended.

IN-SITU CONCRETE SLAB FLOOR

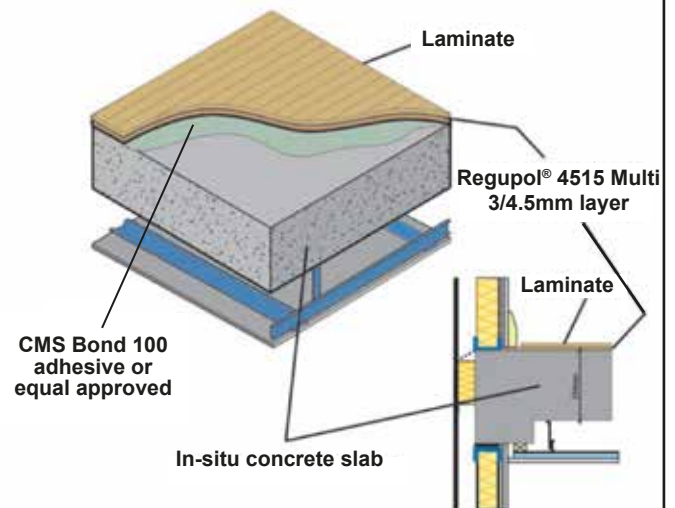

Diagrams are for example purposes only

IN-SITU CONCRETE SLAB FLOOR ON PERMANENT HOLLOW RIB STEELDECK

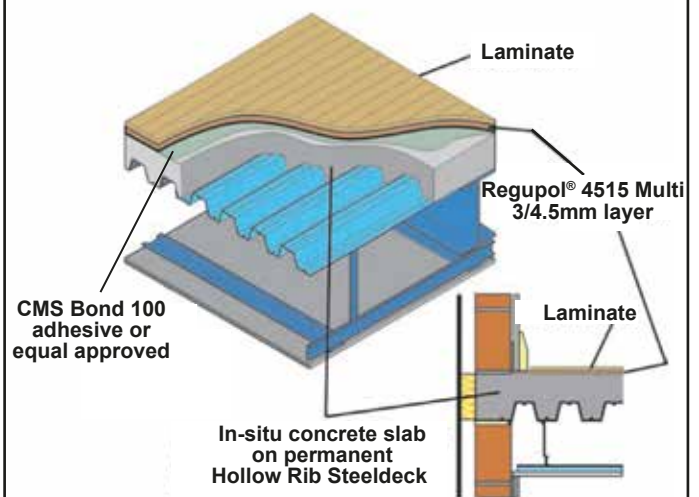

Diagrams are for example purposes only

Regupol® and Regufoam® are registered trade marks of BSW GmbH

Scotland Office:

1 Netherton Road, Wishaw ML2 0EQ

Central/Southern Office:

Unit 2 Lyncastle Road, Warrington, Cheshire WA4 4SN

email: info@cmsdanskin.co.uk website: www.cmsdanskin.co.uk

t: 01698 356000 f: 01698 372222

t: 01925 577711 f: 01925 577733