

# isocheck™

## 27C, 23C 18C & 14C Systems

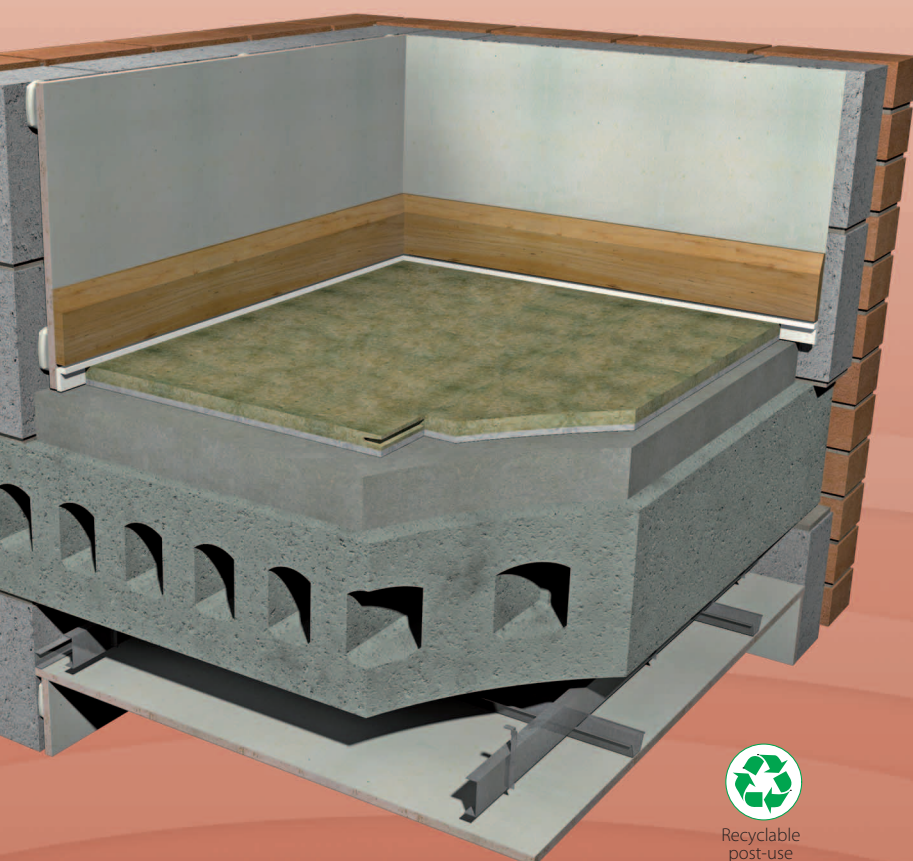

Recyclable  
post-use

### OVERLAY PLATFORM SYSTEM FOR CONCRETE FLOORS

- New build
- Refurbishments
- Conversions
- Robust detail compliant



Taking the *mystery* out of Acoustics

### DESCRIPTION

- Isocheck 27C, 23C, 18C & 14C systems are designed to reduce airborne sound transmission and also reduce impact sound transmission through concrete floors.
- Isocheck 27C, 23C & 18C consist of a 6mm layer of cross linked Isopoli bonded to 22mm, 18mm and 12mm P5 V313 moisture resistant chipboard respectively, whereas Isocheck 14C consists of a 5.5mm layer of cross-linked Isopoli bonded to 9mm moisture resistant medium density fibreboard.
- When installed as part of a complete party floor construction it enables a concrete floor to meet the sound transmission standards of ADE 2003 and subsequent amendments in 2004, 2010, 2013 & 2015.

### APPLICATIONS

- To be used over concrete floors for new build projects, refurbishments and conversions.



Isocheck 23C

## Product data

|                  |                                 |                       |
|------------------|---------------------------------|-----------------------|
| Overall size:    | Isocheck 27C                    | 2400mm x 600mm x 27mm |
|                  | Isocheck 23C                    | 2400mm x 600mm x 23mm |
|                  | Isocheck 18C                    | 2400mm x 600mm x 18mm |
|                  | Isocheck 14C                    | 1200mm x 600mm x 14mm |
| Resilient layer: | 5.5mm Isopoli cross linked foam |                       |
| Weight:          | Isocheck 27C                    | 22.8kg per sheet      |
|                  | Isocheck 23C                    | 18.8kg per sheet      |
|                  | Isocheck 18C                    | 13.0kg per sheet      |
|                  | Isocheck 14C                    | 5.15kg per sheet      |

## Performance (on the constructions illustrated)

| Treated floor with: | $D_{nT,w} + C_{tr}$ | $L'_{nT,w}$ |  |
|---------------------|---------------------|-------------|--|
| Isocheck 27C        | <b>53dB</b>         | <b>54dB</b> | Complies with New Build Robust Detail descriptive FFT5 within E-FC-1, E-FC-2 and E-FS-1. |
| Isocheck 23C        | <b>53dB</b>         | <b>53dB</b> |  |
| Isocheck 18C        | <b>51dB</b>         | <b>53dB</b> |  |
| Isocheck 14C        | <b>51dB</b>         | <b>52dB</b> |  |

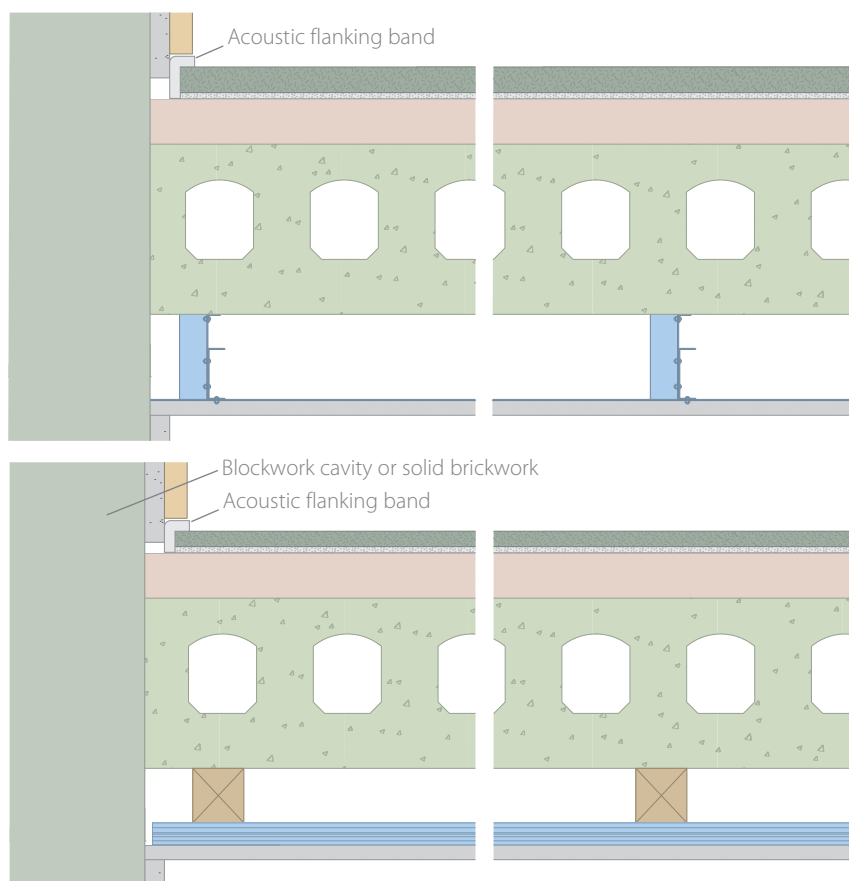

- ❑ Isocheck 27C, 23C, 18C or 14C.
- ❑  $\geq 300\text{kg/m}^2$  hollow core concrete with  $80\text{kg/m}^2$  sand/cement screed or 40mm screed.
- ❑ min. 75mm void formed by metal frame suspended ceiling system with  $\geq 10\text{kg/m}^2$  gypsum board ceiling (top) **or**
- ❑ 50 x 75mm timber battens.
- ❑  $\geq 10\text{kg/m}^2$  gypsum board ceiling supported on resilient bars @ 400mm centres, perpendicular to the battens min 75mm below underside of sub-floor.

Every effort has been taken in the preparation of this sheet to ensure the accuracy of representations contained herein. Recommendations as to the use of materials, construction details and methods of installation are given in good faith and relate to typical situations. However, every site has different characteristics and reliance should not be placed upon the foregoing recommendations. Advice can be given as to specific applications of the products, upon request to isomass building products.

**www.isomass.co.uk**

## SPECIFICATION

The acoustic floor shall be:

- ❑ Isocheck 27C, 23C, 18C or 14C system, supplied by Isomass Ltd. Unit 14 Papworth Business Park, Stirling Way, Papworth Everard, Cambridgeshire CB23 3GY and installed in accordance with manufacturer's instructions / recommendations.

## INSTALLATION

- ❑ Lay isocheck 27C, 23C, 18C or 14C over dry level screed, in brick bond pattern, applying Isocheck adhesive to all tongued and grooved panel joints.
- ❑ Apply Isocheck Acoustic Angled Flanking Band on the edges of the Isocheck boards just before they are pushed against the perimeter walls to isolate the board from the wall.
- ❑ Install skirting and trim off excess Flanking Band.
- ❑ May also be installed in conjunction with underfloor heating systems.
- ❑ Full installation instructions are available and must be used in conjunction when laying this floating floor system.

For advice on treatment of services and penetrations, contact us, consult our brochure or visit our website.

**isomass**  
building acoustics

Isomass Limited, Unit 14 Papworth Business Park,  
Stirling Way, Papworth Everard, Cambridgeshire CB23 3GY

Tel: 0330 175 8228 • Fax: 01223 651 530  
Email: info@isomass.co.uk • www.isomass.co.uk