

Promat



Promat SUPALUX® SPECIFIERS GUIDE

The Ultimate High Performance Fire Protection Board

An infographic for Promat SUPALUX® featuring a central logo and numerous benefits listed in angled text boxes. The background is dark blue with a light blue border.

Promat | **SUPALUX®**

- 30-240 minutes fire protection
- 30+ years of proven performance
- Independently tested
- 3rd party certified
- Multiple applications
- Class 0 rated
- Technical expertise
- Early installation, before building is watertight
- Slim constructions
- Easy to work, fix and decorate
- Non-combustible
- Support from concept to completion
- Manufacturer's inspection and certification scheme
- Up to 80°C working temperature
- CE marking
- Will not rot, deteriorate or decay

Promat SUPALUX® Specified for a reason

When you specify Promat SUPALUX®, you are confirming that there's no room for compromise in fire protection.

You can trust SUPALUX® on every level. That's why it's the UK's leading fire protection board.

No other board can deliver the same peace of mind.

Trusted by professionals

SUPALUX® has been proving its worth for over 30 years. It has physical qualities, practical applications and performance capabilities that go beyond the ordinary. All of which have been verified through rigorous independent testing and certification.

Selecting, specifying and installing SUPALUX® ensures full compliance with recognised UK and European fire protection standards and regulations.

Promat SUPALUX® delivers the ultimate fire protection.

Proven performance

- 30-240 minutes fire protection
- Non-combustible
- Up to 80°C working temperature
- Moisture resistant
- Impact resistant
- Will not rot, deteriorate or decay

Expert support from Promat

Throughout the project, from conception to completion, including:

- Technical helpline
- Onsite inspection
- Compliance certification
- Quality control
- National distribution





Promat SUPALUX® Did you know...?

Unlike many other boards, SUPALUX® has many special performance attributes that have important advantages for all project stakeholders – specifiers, installers and building users:

Calcium silicate composition

SUPALUX® is gypsum free and formulated without inorganic fibres, and does not contain formaldehyde.

This composition provides:

Excellent dimensional stability

SUPALUX® can be used even in damp or humid conditions – and has very low thermal shrinkage.

Moisture resistance

SUPALUX® can be safely installed in semi-exposed environments and before a building is watertight – contributing to a faster build.

Wider working temperature range

SUPALUX® can also be used in higher temperature environments – up to 80°C – such as plant or boiler rooms and protection around diesel generator flues.

Slim constructions

SUPALUX® can be used to create space-saving solid wall partitions without the need for mineral wool.



SUPALUX®
Specified for a reason

Promat SUPALUX® Multiple applications

The qualities and versatility of Promat SUPALUX® make it the first choice for passive fire protection applications in all types of building.

It is equally suitable for specification in both new build and refurbishment projects.

The right solution across all sectors

Promat SUPALUX® assured performance and quality is regularly specified for:

Non-residential

- Offices
- Industrial units
- Warehousing
- Retail outlets
- Schools and colleges
- Hospitals
- Rail and underground network facilities
- Government buildings
- Public buildings

Residential

- Social housing
- Private housing
- Halls of residence
- Care homes

Multi-purpose versatility

SUPALUX® can be relied on to provide fire protection for a wide range of common application needs within buildings.

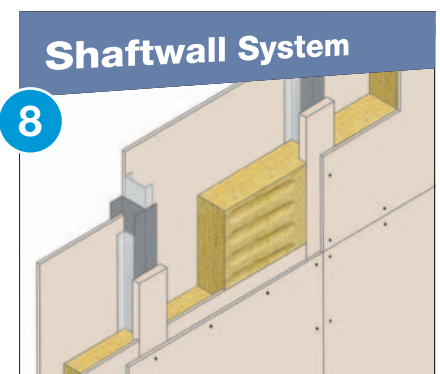
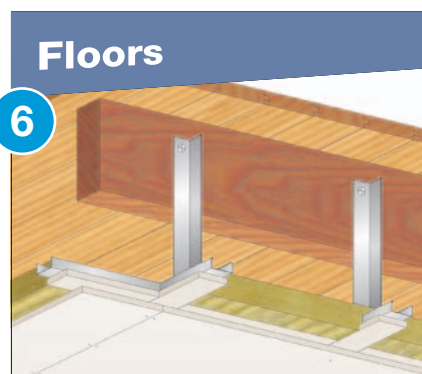
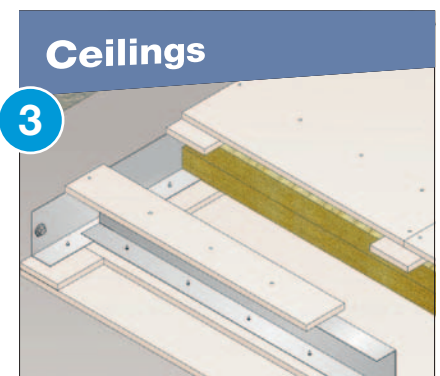
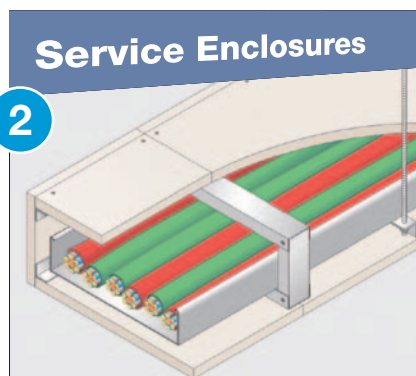
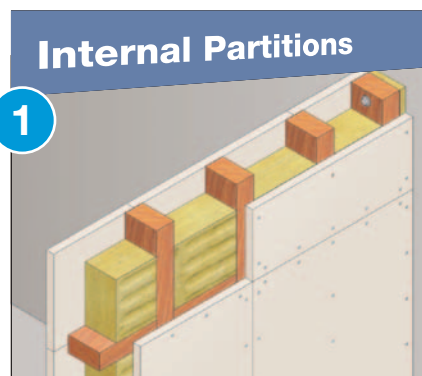

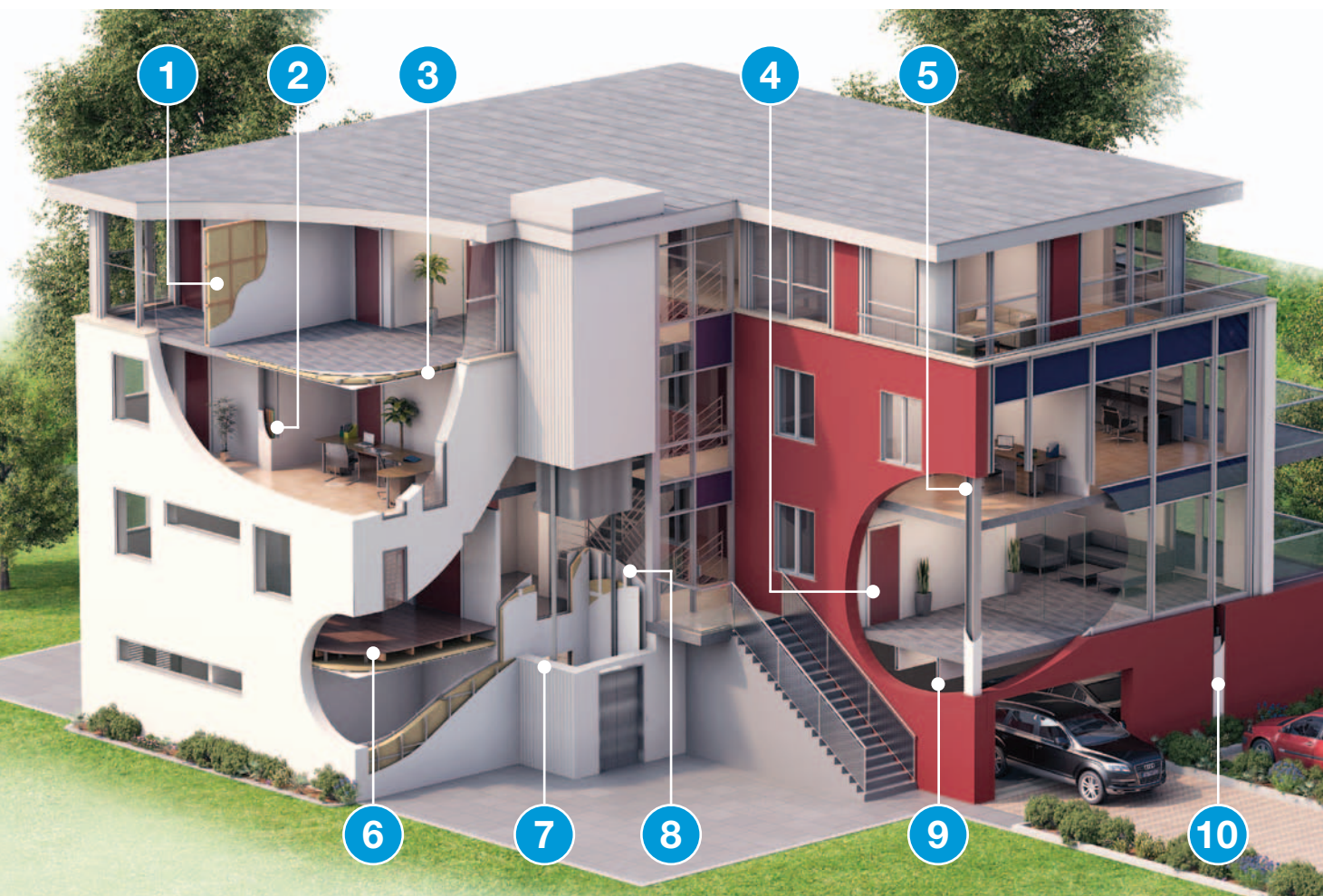

Door Upgrades

4

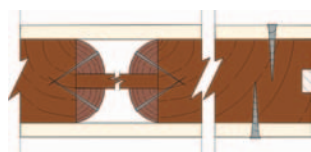

Structural Steel

5

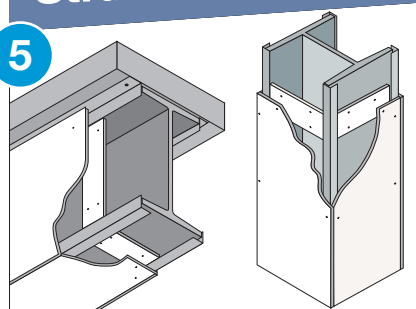

Cavity Smoke Barriers

9

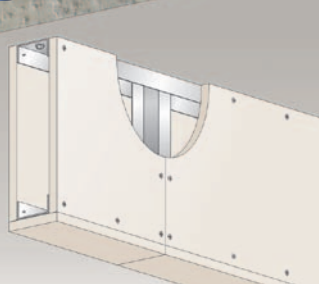

Windposts

10

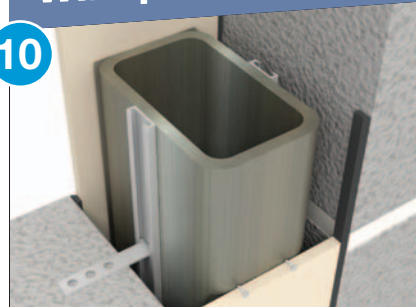

Promat SUPALUX® Did you know...?

Refurbishment applications

SUPALUX® is ideal for adding, or enhancing, passive fire protection within buildings that are undergoing general refurbishment. It can be the answer for specific situations such as:

- Asbestos replacement
- Slim-fitted construction within existing building spaces
- Upgrading the fire performance of existing timber constructions

Promat SUPALUX®
versatility goes even
further >>>

Promat SUPALUX® The answer to application challenges

Some environments within buildings have a particular need to ensure essential fire protection.

These critical application areas require verified performance capabilities that go beyond the scope of most conventional boards.

Promat SUPALUX® is the ultimate passive fire protection board that can be trusted in these situations.



Shaftwall around flues

SUPALUX® can be installed in areas with continuous running temperatures of up to 80°C. These include fire-rated shaftwall for flues serving heating systems and other plant.

Where exposure temperatures exceed 80°C, Promat offer an alternative shaftwall system, Promat MONOLUX® (suitable for continuous running temperatures up to 120°C).

Contact the Promat UK Customer Relations Team for further information.

Other areas with continuous elevated temperatures

These include:

- Boiler rooms
- Plant rooms

Semi-exposed, unheated, damp environments

SUPALUX® can be relied upon in semi-exposed, unheated, damp or humid environments – where passive fire protection is nonetheless essential. These include:

- Soffits, canopies
- Underground and other stations (London Underground Ltd. [LUL] Approved Products Register)
- Car parks
- Integrated garages

Timber door and floor upgrades

SUPALUX® can be cut, drilled and worked to provide an essential extra layer to upgrade fire protection for timber doors or floors, or be used as the fire protection board within fire doors.

Protecting windposts

SUPALUX® can be used as a slim construction to provide fire protection for steel windposts.

Protected zones

SUPALUX® is used to create internal firebreaks within large warehouses where high value stock is held. These protected zones help reduce the implicit risk to business. This may be an insurance requirement. The suitability of SUPALUX® for cold, damp environments can be an extra benefit in such applications.

Where there is a requirement for a non-combustible, heat resistant board, to line walls around high temperature multi fuel heating appliances, exceeding 80°C, Promat PROMAFour-SUPALUX® can be specified (*withstands temperatures up to 1000°C*).
Contact the Promat UK Customer Relations Team for further information.



Promat SUPALUX® Did you know...?

Roof lining for thatched properties

Fire in thatched roofs can be difficult to contain. Whilst the thatch may be expendable, the roof rafters should be protected. SUPALUX® is particularly suitable as a 30 or 60 minute water-resistant fire barrier for rafters. SUPALUX® complies with the 'Dorset Model' recommendations (as featured on Channel 4's *Grand Designs*), endorsed by Local Authorities across the UK.

For more information about these and other challenging applications of SUPALUX®, visit www.promat.co.uk

Promat SUPALUX® Proven in service

Any building which is open to busy daily use – or which has significant contents inside – needs to have fire protection standards that are beyond question.

Promat SUPALUX® has been trusted to provide that assured level of fire protection reliability for many such high profile structures.

In many cases, SUPALUX® has been part of a wider, total solution drawn from the extensive Promat range. This includes other fire protection boards and panels designed for specific application needs within a building, as well as our Promat®-SYSTEMGLAS glazing systems and Promat PROMASEAL® fire-stopping products.

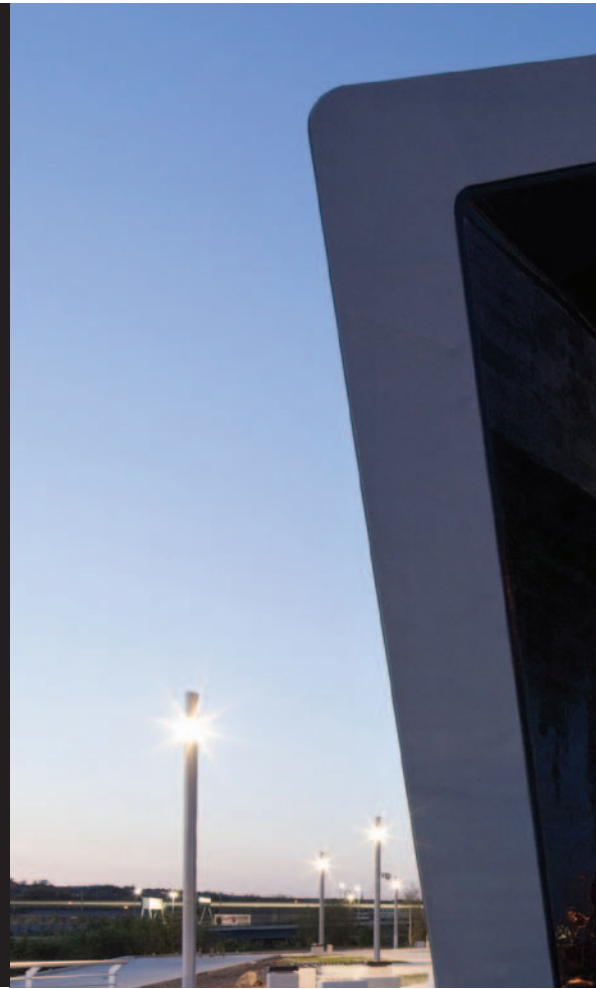

Railway Building: SHEFFIELD PARK, SUSSEX Bluebell Railway Carriage Shed

A new carriage storage shed was required to house vintage carriages at Sheffield Park Station. The semi-exposed structure required the ability to cope with rapid and extreme variations in temperature when engines arrive. The site sits very close to an adjacent industrial building.

Specification required thin, lightweight and easy-to-install solution providing up to 60 minutes EI protection: Promat FLAMEBRAKER™ grid was fitted with SUPALUX® boards.



Public Building: GLASGOW

The Riverside Museum, Scotland's Museum of Transport and Travel

Unique building, involving a challenging design and build. Promat joined the project early to work closely with the architect, main contractor and structural engineering consultants.

SUPALUX® was one of several Promat products used to create a fully-integrated passive fire protection solution. This system is now protecting different areas of the building including structural steelwork and the roof structure.

Image courtesy of McTeer Photograph



Retail: LEEDS – Trinity Leeds Shopping Centre

£350m major retail development with over 1,000,000ft² shopping space in 120+ retail units. This extends Promat's long track record and involvement in large-scale retail projects.

Working with the project team, Promat provided advanced passive fire protection technology and technical expertise to deliver a total solution. A combination of Promat products, including SUPALUX®, now ensures reliable protection for the entire building's integrity.



Transport: LONDON – Civil Engineering

Promat spray and board products, including SUPALUX® are specified for fire protection of steel and concrete structures in rail and underground stations and tunnels.

Our proven systems, LUL accreditation, bespoke solutions, recommended installers and site support presence, have all been key to Promat's long term involvement in these major projects.



Offices: LONDON – 7 More London Riverside

London HQ for PwC: a 650,000ft² office development overlooking Tower Bridge and City Hall.

Over 5000m² of SUPALUX® was fitted to protect the lift shaft walls and risers. A key reason for selection was its enhanced moisture resistance. Installation was completed prior to the building being made water-tight. This enabled other trades to start work sooner and contributed to faster build completion.

No compromise, full compliance

With fire protection, there can never be doubt or compromise about standards. Promat SUPALUX® complies with, or exceeds, recognised UK and European standards and regulations relating to passive fire protection.

Exhaustive and regular testing is undertaken to ensure that total performance reliability is sustained. This testing is carried out independently by third parties including Exova Warringtonfire and BRE Global.



Promat SUPALUX® certifications include:

**Building Regulations
Approved Document B**

Class 0 classification.

Certifire Certification No. CF420

Covering use for:

- Suspended ceilings
- Ceiling membranes
- Timber floor upgrades
- Concealed grid ceilings
- Timber roof voids

Certifire Certification No. CF420A

Covering use for:

- Timber stud partitions
- Steel stud partitions
- Solid partitions
- Shaftwalls
- External walls
- Conversion of external to internal walls



CE Marking

Promat SUPALUX® is compliant with all relevant EU legislation (ETA No: 07/0176).



London Underground Limited

Approved Products Register.

Promat fire testing

We are fully-committed to delivering the continued reliability and trust on which Promat's long-standing reputation is founded.

- Promat UK: 500+ independently-conducted fire resistance tests
- Promat Group: 2,500+ tests since 1988

Promat UK is fully committed to delivering quality product, advice, service and support and is accredited to BS EN ISO 9001, ISO 14001 and OHSAS 18001.

Total support for specifiers

Promat's expertise and comprehensive support is provided to assist with selection, design, specification and certification – as well as guidance and training for installers.

The Promat Customer Relations Team is available on-line or on-call to provide specific commercial and technical advice.

Active support

Our dedicated external technical sales team actively participates in projects in the following ways:

- Design meetings and project planning discussions
- Communication with developers and builders
- Joint meetings with main contractors and installers

Services

Promat can also provide, by arrangement:

- AutoCAD drawings
- Specification clauses
- Engineering judgements
- Site Inspection reports
- Certificates of conformity
- Letters of recommendation

Promat is represented on RIBA NBS Plus. This allows architects and designers to specify products quickly and accurately by importing product information and clauses directly into specifications.

More information at

www.riba-insight.com/products/nbsPlus

Website

Promat provides a comprehensive range of information and downloads through its website, including:

- Fire Protection Handbook
- Product and Application Guides
- Technical Data Sheets
- Safety Data Sheets
- Third party certifications

Visit www.promat.co.uk



Promat SPEC SELECT®

This unique on-line tool is available to assist selection of the most appropriate Promat passive fire protection system for each specific application.

Guidance is provided for structural steel, ceiling, floor, roof and partition applications. This gives access to product information and system specifications. Registered users can also obtain downloadable CAD details and Safety Data Sheets.

View SPEC SELECT® at

www.promat.co.uk/spec-select

RIBA CPD

Promat is part of the RIBA CPD Providers Network and can help contribute to your required 35 hours Continuous Professional Development.

Promat CPD presentations provide a valuable contribution to construction professionals.

Request CPD presentation at

www.promat.co.uk/online-cpd



Promat SUPALUX® Specified for a reason

Promat is a market leader in passive fire protection and high performance insulation. The company has pioneered the development of products that protect lives and livelihoods for over 50 years.

Promat UK is a subsidiary of Promat International, part of the Etex Group of companies.

For further Promat SUPALUX® information call the dedicated SUPALUX® Technical Helpline:

01344 381 378

Or Email: technicaluk@promat.co.uk

(Please quote Ref Promat SUPALUX® PO62)

www.promat.co.uk/supalux-specify

Promat



Promat UK Limited

The Sterling Centre, Eastern Road, Bracknell, Berkshire RG12 2TD
Tel: 01344 381 300 Fax: 01344 381 401 Email: salesuk@promat.co.uk
www.promat.co.uk