

Insulation fixed to underside of the slab

S/1

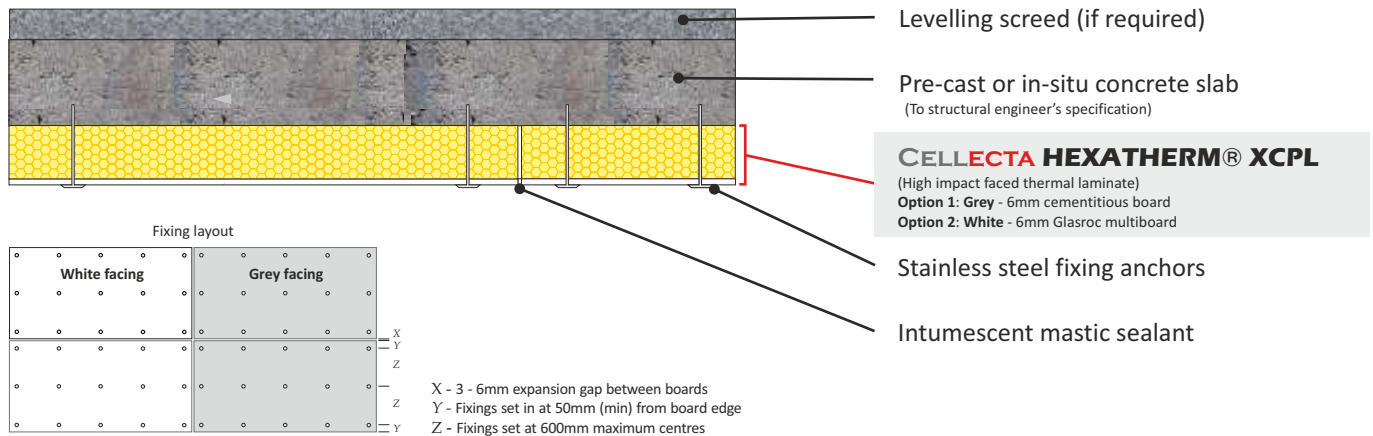

FASTRACKCAD
ARCHITECTURAL CAD DATABASES

nbsPlus

FASTRACKBIM
ARCHITECTURAL BIM DATABASES

Product Information

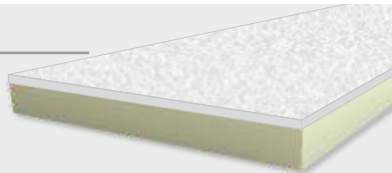

XCPL combine the benefits of a high performance extruded polystyrene with a facing board to produce a composite thermal board to suit car park and soffit lining applications.

Product Benefits

- Smooth high impact facing
- Excellent life-long thermal performance
- Available in two colours: White & Grey
- Easy to install

Physical Properties

	XCPL
Thermal Conductivity EN 12667 (W/mK)	≤80mm 0.033 ≥81mm 0.034
Strength at 10% compression EN 826 (kPa)	≤30mm 250 ≥40mm 300
Strength at 2% compression EN 1606 (kPa)	≤30mm 80 ≥40mm 125
Long term water absorption by immersion EN 12087	0.7%
Temperature range	-50/+75 °C
Board size (mm)	1200 x 2400
Overall thickness' including 6mm high impact class O facing (other sizes manufactured to order)	26 31 36 46 56 66 81 86 106 126 146 166
Edge profile	Square

Typical Thickness of Insulation Required

Thickness of concrete slab (mm)	HEXATHERM® XCPL (mm)				
200	120	140	160	170	190
150	120	140	160	170	290
	0.25	0.22	0.20	0.18	0.16
	U-value (W/m ² K)				
	Calculated in accordance with ISO 13370				

Third Party Accreditation and Approvals



Environmental Credentials



Code for Sustainable Homes

The following Code for Sustainable Homes credits are obtainable as a result of incorporating **HEXATHERM®** into the construction detailed.

Pol 1	
HEXATHERM XPS boards	
GWP value	<5
Code credits	1

Note: Pol.1 Code credits have an approximate weighted value of 0.7