

# Basement walls

## Basement Wall and Floor

Insulation installed externally against retaining wall  
 Insulation installed below floating screed

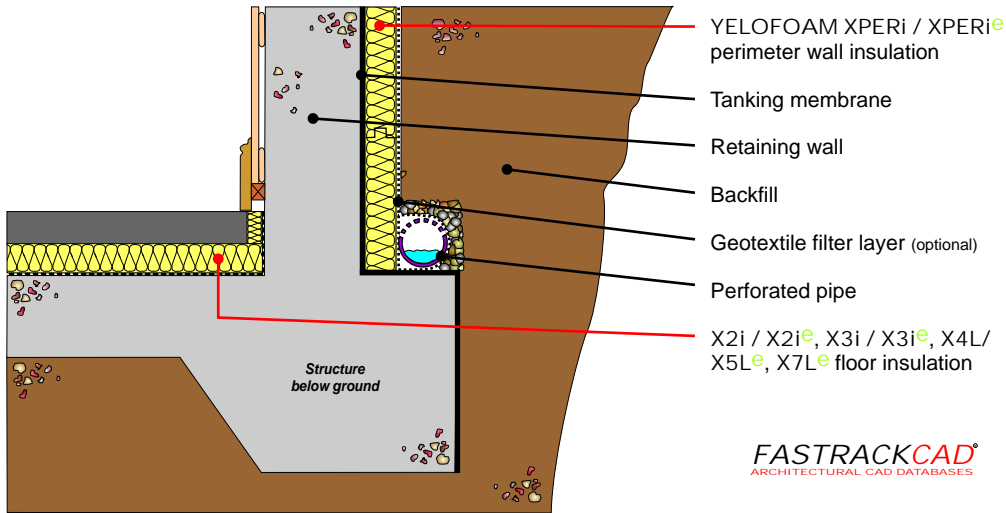

**Calculating the thickness of Insulation Required for Basements**  
 The method of calculating the U-value of a basements is more complex than other applications. Contact *Collecta* for assistance  
 T. 08456 71-71-74.  
 E. technical@collecta.co.uk

**FASTRACKCAD**  
 ARCHITECTURAL CAD DATABASES

GWP value	Pol 1	
	eco XPS boards	YELOFOAM XPS boards
	<5	≥5
Code credits	1	0

Note. Pol.1 Code credits have an approximate weighted value of 0.7