

Celotex CW4000 is an insulation board aimed specifically at partial fill cavity wall applications.

With low emissivity foil facings, CW4000 is manufactured from rigid polyisocyanurate (PIR) using a blowing agent that has zero ozone depletion potential (zero ODP) and low global warming potential (GWP).

With Celotex CW4000 you are specifying an insulation board that:

- Comes in conveniently sized boards for installation between cavity wall ties
- Achieves an A+ rating when compared to the BRE Green Guide
- Is certified under BBA certificate number 94/3080
- Includes low emissivity foil facings giving improved thermal insulation performance within cavity air spaces
- Future proofs energy performance of new and existing buildings

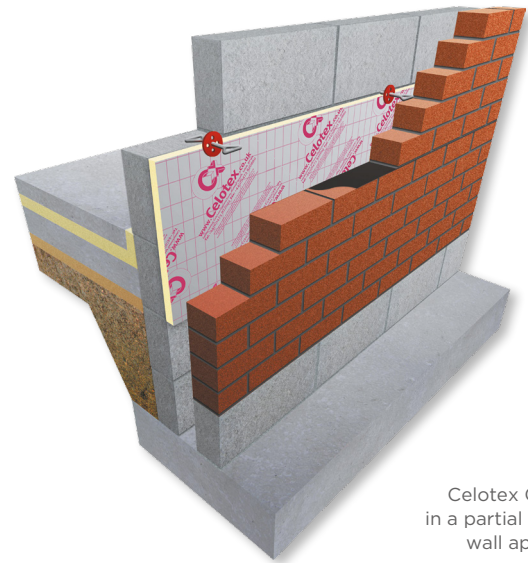

Celotex CW4000 in a partial fill cavity wall application

Applications

Celotex CW4000 is specifically for use in partial-fill cavity wall applications.

Specification clause

The insulation shall be Celotex CW4000 ____mm thick comprising a polyisocyanurate rigid foam insulation core with a thermal conductivity of 0.022 W/mK with low emissivity aluminium foil facings on both sides. Celotex CW4000 is CFC/HCFC free with zero ODP and low GWP and CE marking compliance to BS EN 13165. Celotex CW4000 is manufactured in accordance with quality management system ISO 9001 and environmental management system ISO 14001. Celotex CW4000 achieves an 'A+' rating when compared to the BRE Green Guide. All products must be installed in accordance with instructions issued by Celotex.

Technical data

Thickness (mm)	R-value (m ² K/W)	Weight (kg/m ²)
40	1.80	1.26
50	2.25	1.55
60	2.70	1.90
75	3.40	2.34
85	3.85	2.62
100	4.50	3.27

Physical properties

	Method	CW4000
Compressive strength	BS EN 826	≥120kPa
Dimensional stability	BS EN 1604	DS (70, 90)3, DS (-20,-)1
Water vapour resistance	BS EN 12086: Method B	>150 MNs/g
Thermal conductivity	BS EN 12667	0.022 W/mK
Surface spread of flame	BS 476-7	Class 1 (25mm - 90mm only)

Typical U-values

U-values will vary depending on application. To calculate a specific U-value, please visit our online calculator at celotex.co.uk

Installation guidelines

For Celotex CW4000 installation details please refer to our online 'applications' pages.

Further information

If you wish to contact Celotex, please do so through the 'contact us' page on our website.

For information regarding storage, installation and handling of Celotex products, or for health & safety advice, please refer to our online 'literature' pages.

Celotex has a policy of continuous product development and reserves the right to alter product designs or specifications without prior notice.

Saint-Gobain Construction Products UK Limited trading as Celotex. Registered Office: Saint-Gobain House, Binley Business Park, Coventry CV3 2TT. Registered in England and Wales No 734396