

DRYPANEL 28WF

Description

DryPanel 28WF is an acoustic overlay treatment board with a T&G profile. Made from reinforced cement fibre board of flat surface, reinforced by natural minerals on both sides. These dry-fit screed replacement panels at only 28mm thick offer minimal floor height and save on drying times compared to traditional screeds. DryPanel 28WF high density provides excellent airborne sound performance through many types of separating floors, alongwith impact sound reduction due to its acoustic resilient layer (WF) wood fibre. It's top layer, is a high performing multipurpose building board that's designed purposely to provide fireproof, acoustic and waterproof protection, with very high dimensional stability which makes it a high performance alternative to Gypsum and Cement Particle for any construction type.



DryPanel 28WF

DryPanel 28WF is a Cement Fibre Board with a high density of 1350 kg/m³ to act as an acoustic overlay.

Advantages:

- Saves on drying times to that of traditional screeds.
- Resistant to damp, moisture and water.
- Offers excellent airborne sound performance.
- Can be laid directly, without a decoupling mat.
- Resistant to impact.
- Environment friendly, asbestos free.
- Insect-proof, non putrescible, no moulding.
- UV stable.
- Easy to cut and install.
- High density of 1350 Kg/m³.
- Non combustible.

Applications:

- Suited to both a timber joist and steel joisted floor.
- Can also be used as part of a build up onto a Metsec style decking

Sitework: Specialist cutting blades for cutting boards, use [Polycrystalline Diamond \(PCD\)](#) Fibre Cement Blades with a flat tooth configuration.

Technical Properties

Panel Dimension	1200 x 600 mm (0.72 m ²)
Modulus Of Rupture Value	>7 EN12467 (wet) >10 EN12467 (dry)
Fire Propagation	Class "0" (<2) BS476 Part 6
Fire Resistance	Class 1 BS476 Part 7
Combustibility	Non-Combustible - BS476 Part 4
Fire integrity	120 mins BS476-20
Water Impermeability	Pass

Board Characteristics

Thicknesses	(indication of kg/m ² for thicknesses) 28mm
Density	1350 kg/m ³ (- 50 kg)



Typical Acoustic Performance

Concrete Insitu Floor DnT,w + Ctr

54dB

LnT,W (with 4.5mm resilient layer)

40dB

ΔLw (with 4.5mm resilient layer)

19dB

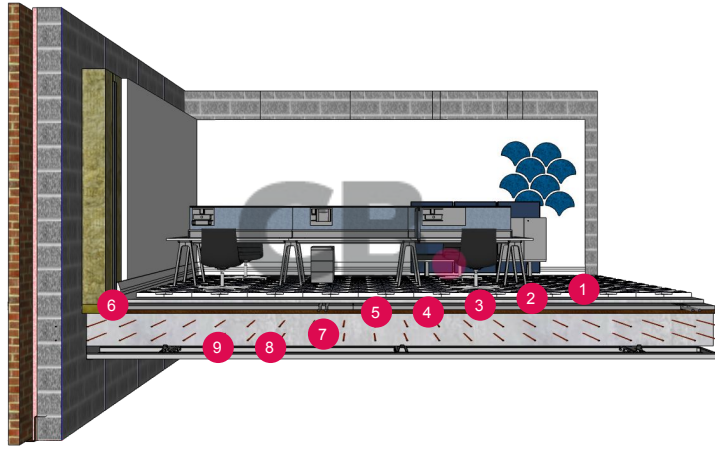

1. Ceramic Tiles
2. Electric UFH cables set in tile adhesive
3. DryPanel 28WF
4. Routed UFH insulation
5. 4.5mm resilient layer
6. L Shaped Flanking Strip
7. 200mm Reinforced insitu concrete slab
8. MF ceiling (min 100mm void)
9. 1 x 9.5mm acoustic plasterboard

Timber Joist Floor DnT,w + Ctr

52dB

LnT,W (with 4.5mm resilient layer)

58dB

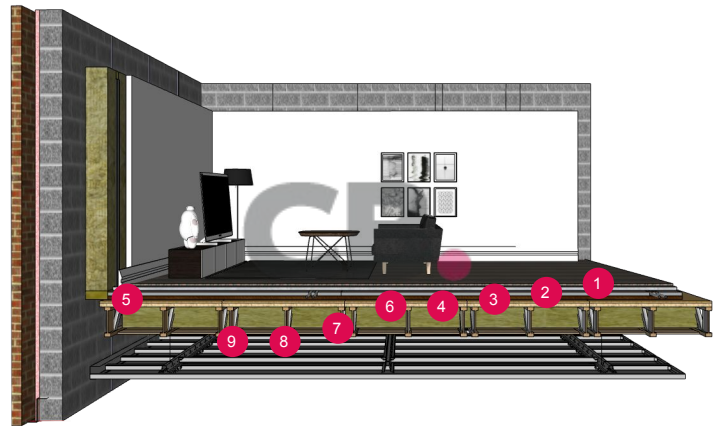

1. Carpet and Underlay
2. DryPanel 28WF
3. Routed UFH insulation
4. 4.5mm resilient layer
5. L Shaped Flanking Strip
6. Chipboard Structural Deck
7. Minimum 25mm timber floor joists
8. Heavy duty resilient bars
9. 2 x 15mm acoustic plasterboard

Steel Joist Floor DnT,w + Ctr

55dB

LnT,W (with 4.5mm resilient layer)

58dB

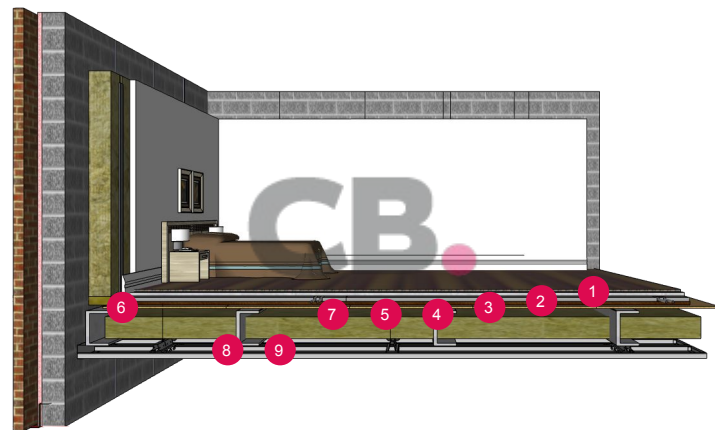

1. Sheet vinyl or LVT flooring
2. Adhesive layer (self levelling)
3. DryPanel 28WF
4. Routed UFH insulation
5. 4.5mm resilient layer
6. L Shaped Flanking Strip
7. Minimum 25mm timber floor joists
8. Minimum 225mm steel floor joists
9. Heavy duty resilient bars
10. 2 x 15mm acoustic plasterboard

Profiled Metal Decking DnT,w + Ctr

54dB

LnT,W (with 4.5mm resilient layer)

50dB

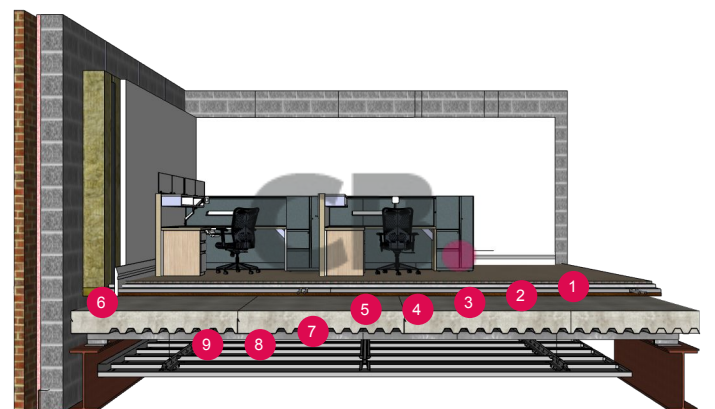

1. Engineered wooden flooring
2. Decoupling layer or adhesive
3. DryPanel 28WF
4. Routed UFH insulation
5. 4.5mm resilient layer
6. L Shaped Flanking Strip
7. 130mm concrete and profiled metal deck
8. MF ceiling (min 100mm void)
9. 1 x 9.5mm acoustic plasterboard