

isocheck™

Screedcheck XL9 System

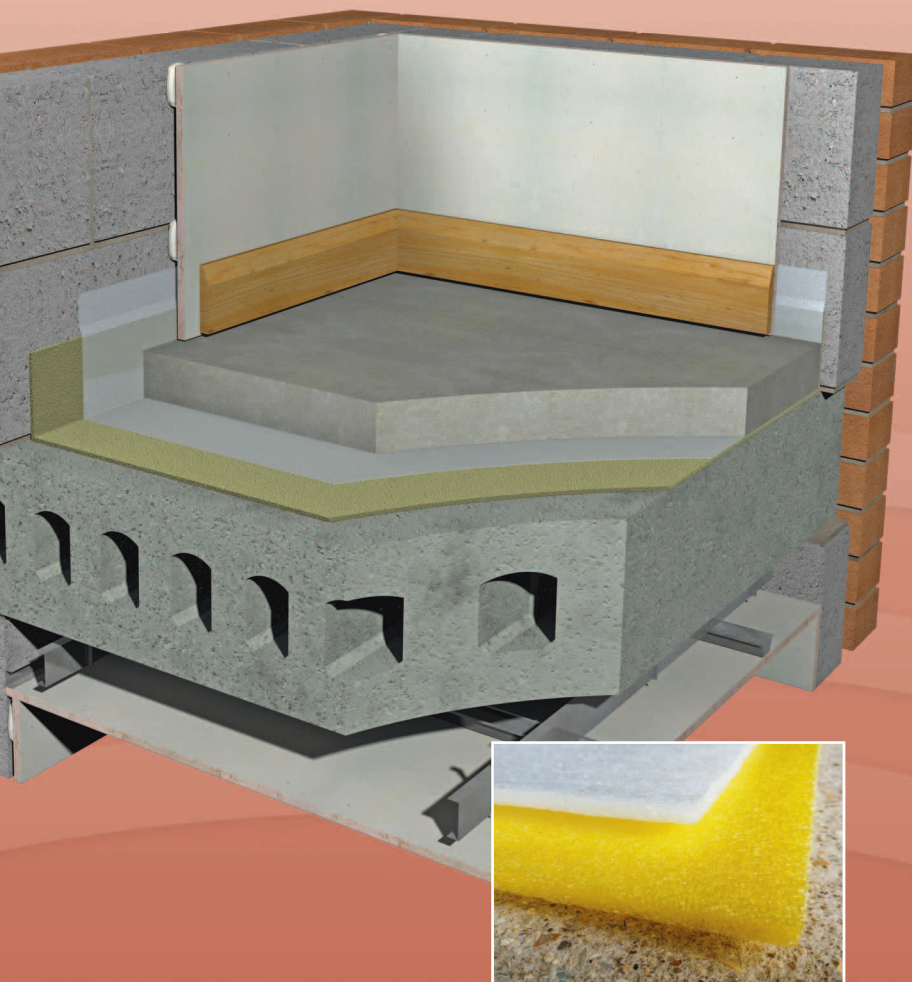

IMPACT IMPROVEMENT SYSTEM FOR CONCRETE FLOORS

- New build
- Conversions



DESCRIPTION

- ❑ The isocheck Screedcheck XL9 system from Isomass features a 9mm closed cell non cross linked foam layer that has been designed to be placed within a masonry structural floor directly below the screed. This isolates the screed from the structural sub floor, and provides sufficient impact absorption to place it amongst the top performing systems available.
- ❑ By ensuring that all the joints are taped, bridging will be eliminated which is the single greatest cause of failure of any system of this type.
- ❑ When installed correctly, the XL9 system will enable compliance with Approved Document E 2003 and subsequent amendments in 2004, 2010, 2013 & 2015.

BENEFITS

- ❑ Closed cells prevents water absorption which can impair acoustic performance.
- ❑ All installations over 500m² come with a free site pre screed inspection.

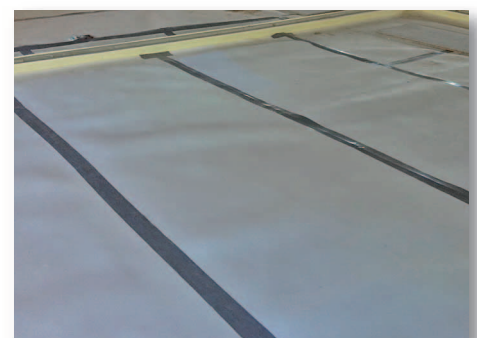

We take the *mystery* out of Acoustics

Product data

Roll dimensions:	1.20m wide x 50m	
Thickness:	9mm	
Foam composition:	Closed Cell Non Cross Linked Isopoli	

Performance (on the construction below)

Treated floor with:	$D_{nT,w} + C_{tr}$	$L'_{nT,w}$
Screedcheck XL9	50dB	≤45dB

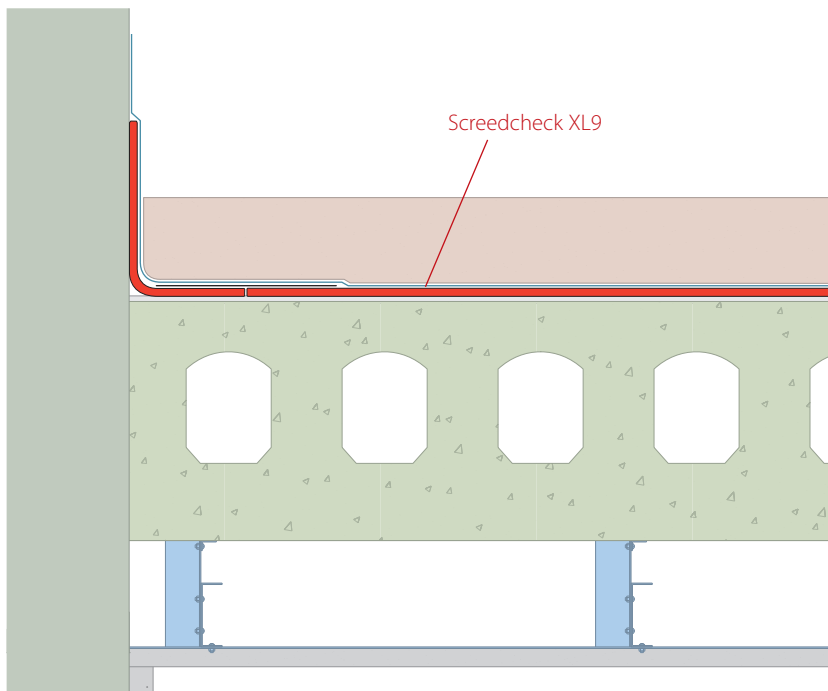

- ❑ min 80kg/m² - 65mm sand cement screed or 40mm liquid proprietary screed.
- ❑ Optional plastic sheeting - to aid screed pouring and maintain joints in Screedcheck XL9.
- ❑ Screedcheck XL9 on grouted sub floor.
- ❑ ≥300kg/m² minimum structural sub floor.
- ❑ 75mm min. void formed by metal frame suspended ceiling system and ≥10kg/m² gypsum board ceiling.

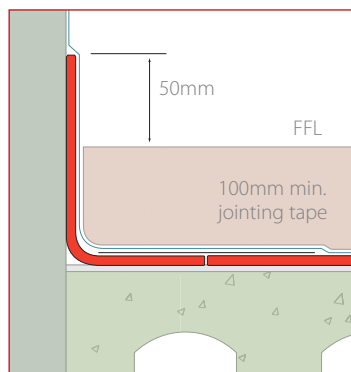

SPECIFICATION

The acoustic floor shall be:

- ❑ Isocheck Screedcheck XL9, manufactured by Isomass Ltd. Units 10 & 11, Avenue Business Park, Off Brockley Road, Elsworth, Cambridgeshire, CB23 4EY and installed in accordance with manufacturer's instructions / recommendations.

INSTALLATION

- ❑ The floor surface should be swept free of any loose debris that may damage or bridge the system.
- ❑ A separate piece of Screedcheck XL9 should be used as a perimeter flanking strip. This piece should be butt-jointed and taped to the main layer and include a minimum 50mm to protrude above the intended FFL of the screed (left).
- ❑ Adjoining roll edges should be butt-jointed and sealed with a minimum 100mm wide jointing tape.
- ❑ Services that penetrate the screed should be isolated by wrapping with Screedcheck XL9 which again would be taped.
- ❑ When trafficking the floor take care not to perform any unnecessary actions that may cause any of the taped joints to be forced apart.

Every effort has been taken in the preparation of this sheet to ensure the accuracy of representations contained herein. Recommendations as to the use of materials, construction details and methods of installation are given in good faith and relate to typical situations. However, every site has different characteristics and reliance should not be placed upon the foregoing recommendations. Advice can be given as to specific applications of the products, upon request to isomass building products.