

ReVerb Ceiling & Wall Panels

Installation instructions



FABRIC FACED PANEL SYSTEM FOR CEILING AND WALLS for

- New build
- Refurbishments
- Conversions



PRODUCT DATA

Panel sizes*:	A wide range of sizes are available as either baffles, wall liners or rafts either cylindrical or in 15 different sizes ranging from 600mm square to 1200mm x 3000mm.
Thickness:	40mm Class A
Weight and composition:	Compressed glass wool framed in MDF and covered in Polyolefin fabric (available in a range of colours)

**Other sizes are available special to order.*

DESCRIPTION

- ❑ Isocheck ReVerb Ceiling and Wall Panels are designed to absorb sound and reduce reverberation noise.
- ❑ The panels feature a compressed glass wool ‘core’ around an MDF frame and then covered with a Polyolefin fabric.
- ❑ The panels are available in three options - two for ceilings and one for walls:
 - Baffle
 - Raft
 - Wall Liner

- ❑ The ReVerb Panels reduce reverberated noise resulting in more productive, safer and comfortable environments, such as education facilities, offices, theatres, recording studios, home cinemas, interview rooms, sports halls, churches, restaurants and civic amenities.

INSTALLATION - GENERAL

- ❑ Installation of the Isocheck ReVerb Panels is straightforward for all options and does not require a specialist fitter or specialist tools.
- ❑ The baffle panels and the raft panels for ceilings are suspended from the supporting structure by steel cables and spiral hooks which fit to the rear face of the panels.
- ❑ Each hanging kit contains a fixing piece and lock, a spiral hook, a locking eyelet hook and a 2m cable.

- ❑ The wall lining panels are fixed to the wall with impaling spikes and spray-adhesive.
- ❑ Fixing locations and step-by-step instructions for all options are shown on the next three pages.

If in doubt on any area, please call Isomass prior to commencement of work.

INSTALLATION - BAFFLE CEILING PANELS

- ❑ Drill a fixing hole in the supporting structure and screw in the base piece (1).
- ❑ Push the plain end of the cable all the way through the base locking piece until the cable stop end and screw the locking piece to the base piece (2).
- ❑ Push the cable through the top of the locking eyelet hook and out the side (3).
- ❑ Insert the spiral hook into the back of the panel and turn clockwise until a tight fit (4).
Fixing locations for the spiral hook for each type of panel are shown on the back page of this installation instructions leaflet.
- ❑ Clip the locking eyelet hook to the spiral hook (5).
- ❑ Place a spirit level on the back of the panel (6) and adjust the height levels by pulling or releasing the end of the cable until the panel is level.
- ❑ Trim off any excess cable with a cable cutter.
- ❑ The panels can be set at an angle to increase design and aesthetic appearance.

CLEANING

Light dirt marks on the panels can be removed by using a proprietary carpet spot cleaner. Test a small area of the panel before treating the full area to ensure the fabric is not adversely affected.

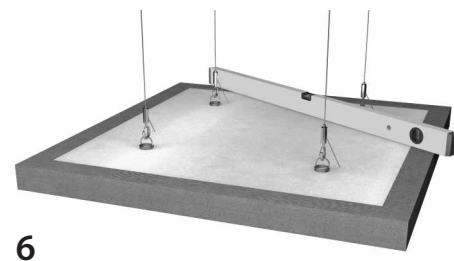
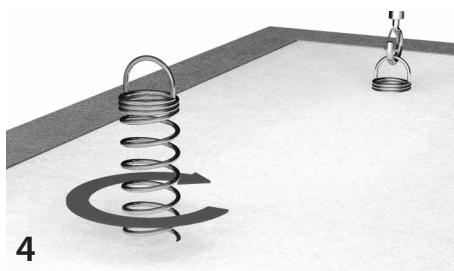
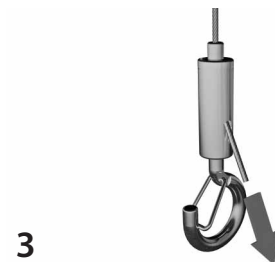

INSTALLATION - RAFT CEILING PANELS

- ❑ Drill a fixing hole in the supporting structure and screw in the base piece (1).
- ❑ Push the plain end of the cable all the way through the base locking piece until the cable stop end and screw the locking piece to the base piece (2).
- ❑ Push the cable through the top of the locking eyelet hook and out the side (3).
- ❑ Insert the spiral hook into the back of the panel and turn clockwise until a tight fit (4).
Fixing locations for the spiral hook for each type of panel are shown on the back page of this installation instructions leaflet.
- ❑ Clip the locking eyelet hook to the spiral hook (5).
- ❑ Place a spirit level on the back of the panel (6) and adjust the height levels by pulling or releasing the end of the cable until the panel is level.
- ❑ Trim off any excess cable with a cable cutter.
- ❑ The panels can be set at an angle to increase design and aesthetic appearance.

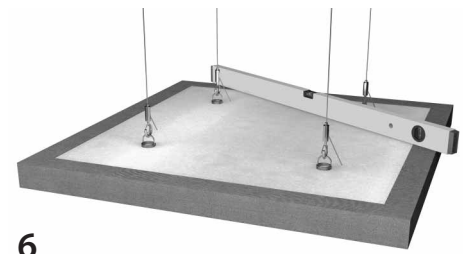
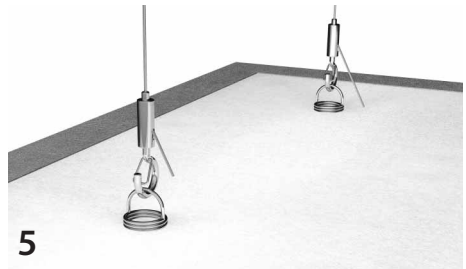
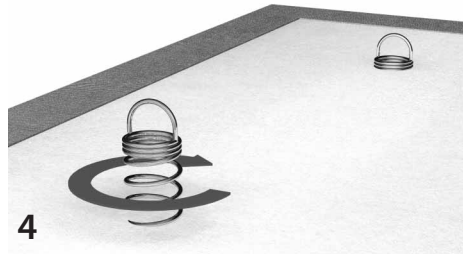
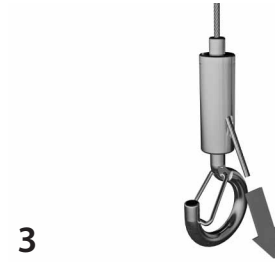

INSTALLATION - WALL LINING PANELS

- ❑ Ensure all walls are dry, clean and free from contaminants. The wall panels can be fitted to all types of walls providing they are solid (inc. blockwork, concrete and plasterboard).
- ❑ Any wallpaper should be removed. Gloss painted walls should be roughened. Emulsion painted walls should be brushed with a stiff brush.
- ❑ Lightly trace out the outline of the panel to be fitted and position the impaling spikes (1) - see location instructions on the back page of this instructions leaflet.
- ❑ Screw-fix the impaling spikes to the wall using suitable fixings (2).
- ❑ Spray contact adhesive to the wall in a horizontal motion (3). Ensure adhesive is also applied to the impaling spikes.
- ❑ Spray contact adhesive to the panel in a vertical motion (4). The adhesive should be applied to 100% of both surfaces.
- ❑ Wait 2-5 minutes (at 23°C) for the adhesive to become tacky.
- ❑ Line up the panel with the outline on the wall and push the panel gently into the impaling spikes (5). Once the panel is aligned correctly, press the panel firmly over all the area to ensure full contact with the wall.

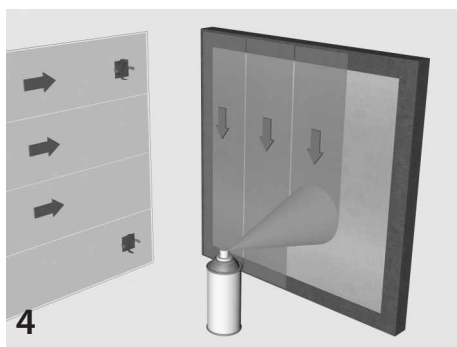
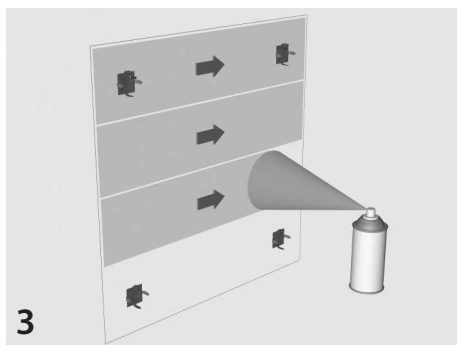
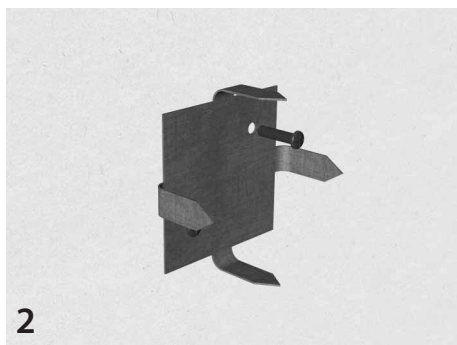
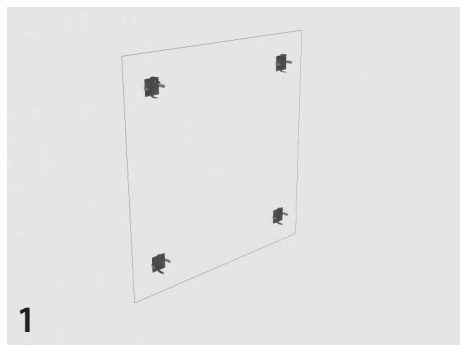

FIXING LOCATIONS - BAFFLE AND RAFT CEILING PANELS

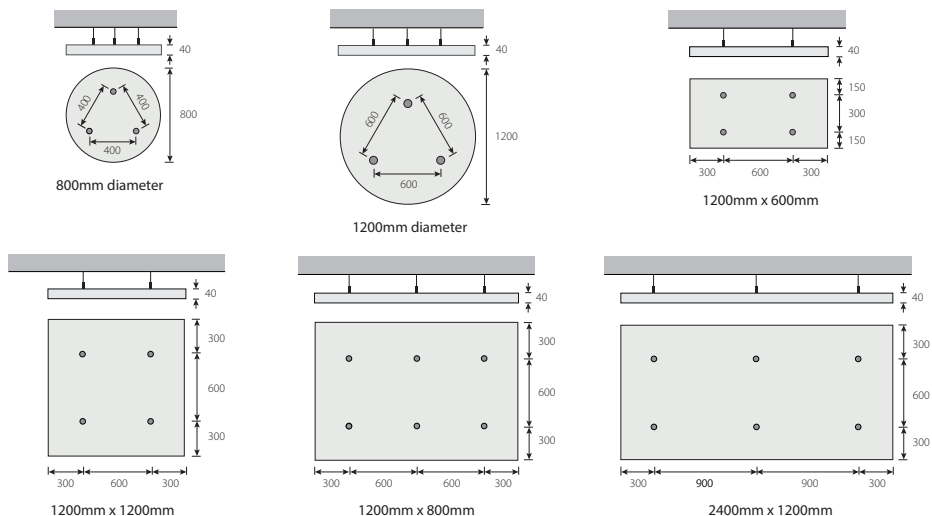

FIXING LOCATIONS - WALL LINING PANELS

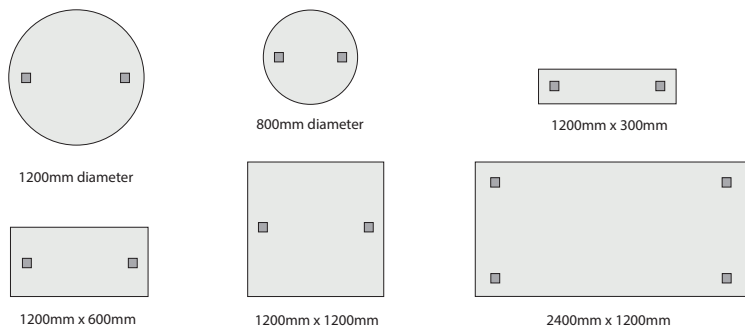

Two impaling spikes are recommended for circular panels up to 1200mm diameter and square panels up to 1200mm x 1200mm.

Four impaling spikes are recommended for panel sizes with any side or diameter above 1200mm.

Every effort has been taken in the preparation of this sheet to ensure the accuracy of representations contained herein. Recommendations as to the use of materials, construction details and methods of installation are given in good faith and relate to typical situations. However, every site has different characteristics and reliance should not be placed upon the foregoing recommendations. Advice can be given as to specific applications of the products, upon request to isomass building products.