

# Acoustic SoundBoard Supreme 24

HIGH PERFORMANCE SHALLOW OVERLAY BOARD

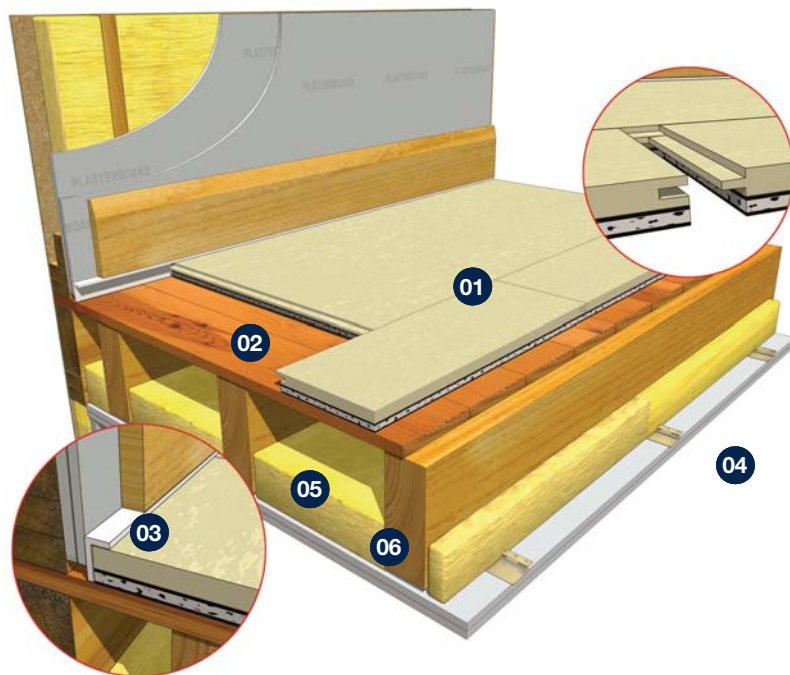

Datasheet 73



- 01 JCW SoundBoard Supreme 24
- 02 Existing Subfloor
- 03 JCW L Shaped or Flat Perimeter Edging Strip detail
- 04 Resilient Bars and 2 layers x 15mm Acoustic Plasterboard
- 05 100mm x 45kgs/m<sup>3</sup> Mineral Wool Slab
- 06 235mm depth Timber Joists



**Product Code:** 1437

MDF based premium acoustic overlay board

**Acoustic Floating Floor:** Moisture Resistant 9mm t&g MDF board with a pre-bonded 15mm high performance resilient layer

#### Refurbishment

- Ideal for both general and new domestic separating floor upgrades in lofts and extensions etc
- Enhanced Impact and Airborne sound reduction via superior 15mm barrier-foam-barrier pre-bonded backing
- Ideal decking for floated wood, laminate, carpet/carpet tiles. Additional floor preparation will be required for tiling and vinyl overlays

#### PCT/PT

- Economical system for both Conversion & New Build projects
- It is essential recommended components shown above are used and correctly installed/detailed to meet the requirements where Pre-completion Sound Testing is required

**Sheet Size:** 24mm x 600mm x 1200mm (0.72 m<sup>2</sup>) **Weight:** 12.5 kgs m<sup>2</sup>

BRE LAB TEST DATA: **TEST NO:** L216-009, L216-010

**Airborne:** Rw - 63 dB Rw + Ctr - 53dB

**Impact:** Ln, w - 48 dB

#### Method of Compliance

PCT/PT (Scotland)

#### Ancillary Products

- 1130 JCW Flat Edging Strip (50 Lm x 150mm x 5mm) or
- 1170 JCW Universal L Shaped Strip (2 Lm x 53mm x 23mm)
- 1196 JCW Waterproof PVA Adhesive (1 Litre)
- 1027 JCW Acoustic Sealant (310ml)

Domestic Dwellings | Offices | Hotels | Conference Centres | Leisure Centres | Schools | Restaurants | Showrooms



Unit 32-34 Waters Meeting Development  
Britannia Way, Bolton, BL2 2HH

Sales helpline **01204 548400**  
8.30am - 5.00pm Monday to Friday

sales@acoustic-supplies.com  
**www.acoustic-supplies.com**

## Basic guidance notes for installation of JCW Acoustic Decking Systems

JCW Acoustic Decking floor panels are supplied in 2 standard board sizes dependant on the material.

### 1. T&G MDF Board 1200mm x 600mm.

The substrate or joists should be flat, dry, and free from all debris. Acoustic boards are best laid towards the end of the project to protect from general trades, high floor loadings and moisture leading to expansion.

- The floor area/s to be overlaid should be carefully planned prior to commencing installation to minimise wastage. There are two overlay board types; **1) Non-Structural** onto an existing sub-floor. **2) Structural** for Direct to Joist. The boards must be laid on to flat or levelled joists in the opposite direction of the joists. Direct to Joist boards can also be laid onto an existing sub-floor.
- Ensure that the wall surfaces are prepared (plaster skimmed or plaster boarded down to the level of the sub-deck). Any gaps will facilitate the unwanted transmission of sound via the wall edges.
- Apply 5mm foam flat wall **JCW Perimeter Edging Strip** or **L shaped strips** to the base of all perimeter walls allowing approximately 15mm excess foam above the finished acoustic board height, this can later be folded down on top of the acoustic floor surface to isolate the skirting boards. Any unwanted excess foam can then be cut back with a sharp knife.
- Remove any tongues at the wall edges, then cut & scribe the first corner board into place and butt up to (do not compress the JCW Perimeter Edging Strip) the Edging Strip. All T&G board joints must be fully adhesive bonded using our recommended adhesive. The last board in the first row should be cut to length and the off-cut carried forward to begin the second row.
- Proceed with the second and successive rows ensuring that all board joints are staggered. The last row of boards will require accurate cutting & scribing to butt up to the wall. **Any minor gaps** between the **JCW Perimeter Edging Strip** and the acoustic board must be filled with JCW Acoustic Sealant/Mastic. It is imperative that the JCW Perimeter Edging Strip **is not compressed** in order to maintain acoustic isolation and an allowance for expansion.
- **At doorways:** the acoustic floor **should not be continuous** with adjoining areas. At the door threshold leave a 5mm gap between the adjoining acoustic boards and fill with JCW Acoustic Sealant. This action will ensure that the acoustic integrity is maintained within the room that is being Sound Tested. Note; if the sub-floor at the doorways is not flat, the acoustic boards may require additional base support to reduce compressive joint movement. Additionally the surface joints could be sanded up to 5mm to level if required.
- The finished floor should not be walked on for a period of up to 24 hours to allow the adhesive to cure undisturbed. NOTE; PVA adhesive will not cure in temperatures below 5° Celsius. Ensure that the board joint adhesive has fully cured prior to overlaying any final floor covering.

Any penetrations through the acoustic floor and beneath the separating ceiling must be correctly detailed and dealt with on a site by site basis.

**Further assistance is available via our Sales and Technical Helpline below.**

## Guidance for using Resilient Bars

Screw fix the pre-drilled section of the resilient bars at 400mm centres and perpendicular to the joists, battens or studs.

Screw fix acoustic plasterboards to the flat underside of the resilient bars, allowing a clearance of 100mm of the supporting timbers.

It is imperative that no screws penetrate through the resilient bar and into the supporting structure.

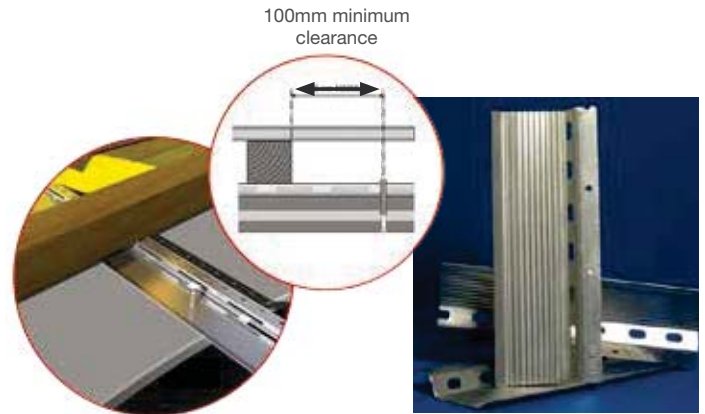

**Disclaimer:** The product and installation information contained in this Data Sheet and General Installation Guide is to the best of our knowledge correct. Please contact us direct, prior to starting works, for the latest information to enable confirmation of the specification.

**NB: RESILIENT BARS ARE SUPPLIED BY OTHERS.**

Domestic Dwellings | Offices | Hotels | Conference Centres | Leisure Centres | Schools | Restaurants | Showrooms



Unit 32-34 Waters Meeting Development  
Britannia Way, Bolton, BL2 2HH

Sales helpline **01204 548400**  
8.30am - 5.00pm Monday to Friday

sales@acoustic-supplies.com  
[www.acoustic-supplies.com](http://www.acoustic-supplies.com)