



## Data/Factsheet

---

Dimensionally stable and robust

---

Installed over pedestals and joists

---

Ideal substrate for stone finishes

---

Non-intrusive access panels

---

High recycled content

---

## Knauf GIFAfloor

Load-bearing partial-access floor systems  
with high dimensional stability

# Knauf GIFAfloor creates strong versatile flooring systems

Knauf GIFAfloor systems use engineered flooring panels with a recycled material content of 50%. Fibres from wholly recycled paper are blended with a mix of natural and flue gas desulphurised gypsum to create non-combustible gypsum fibreboard panels with A1 fire rating.

Knauf GIFAfloor panels are manufactured in a lamination process and pressed to the optimum density, resulting in an inherently strong and consistent product. Engineered tongue and grooved edge profiles ensure a strong bond when laid, creating robust monolithic floors with excellent load-bearing capability, the ideal substrate for natural stone or porcelain finishes. The addition of frames and panels can be incorporated to give access into the void below the floor, and Knauf GIFAfloor's high thermal conductivity makes the panels ideal in underfloor heating systems.

## KEY FACTS

### What is Gifa?

Load-bearing gypsum fibre panels

Ideal substrate for stone finishes

Dimensionally stable & robust

Engineered with tongue and groove edge profile

Suitable for partial access to void

Enhances underfloor heating system performance

Non-combustable A1 fire rating



## Strong, versatile hollow floors for demanding spaces

Knauf GIFAfloor panel systems are designed to span over pedestals at maximum 600mm centres, creating extremely strong and dimensionally stable floors over voids up to 1200mm high. The loading performance can be further enhanced by adding pedestals at reduced centres or an extra panel layer. Knauf GIFAfloor systems create relatively lightweight robust monolithic floors, suitable for car showrooms, airport lobbies, and lightweight floors in high rise buildings. The systems offer flexibility and functionality both above and below the floor. Below, the void is ideal for services and air plenums, and above, partitions can be secured directly onto the Knauf GIFAfloor surface.

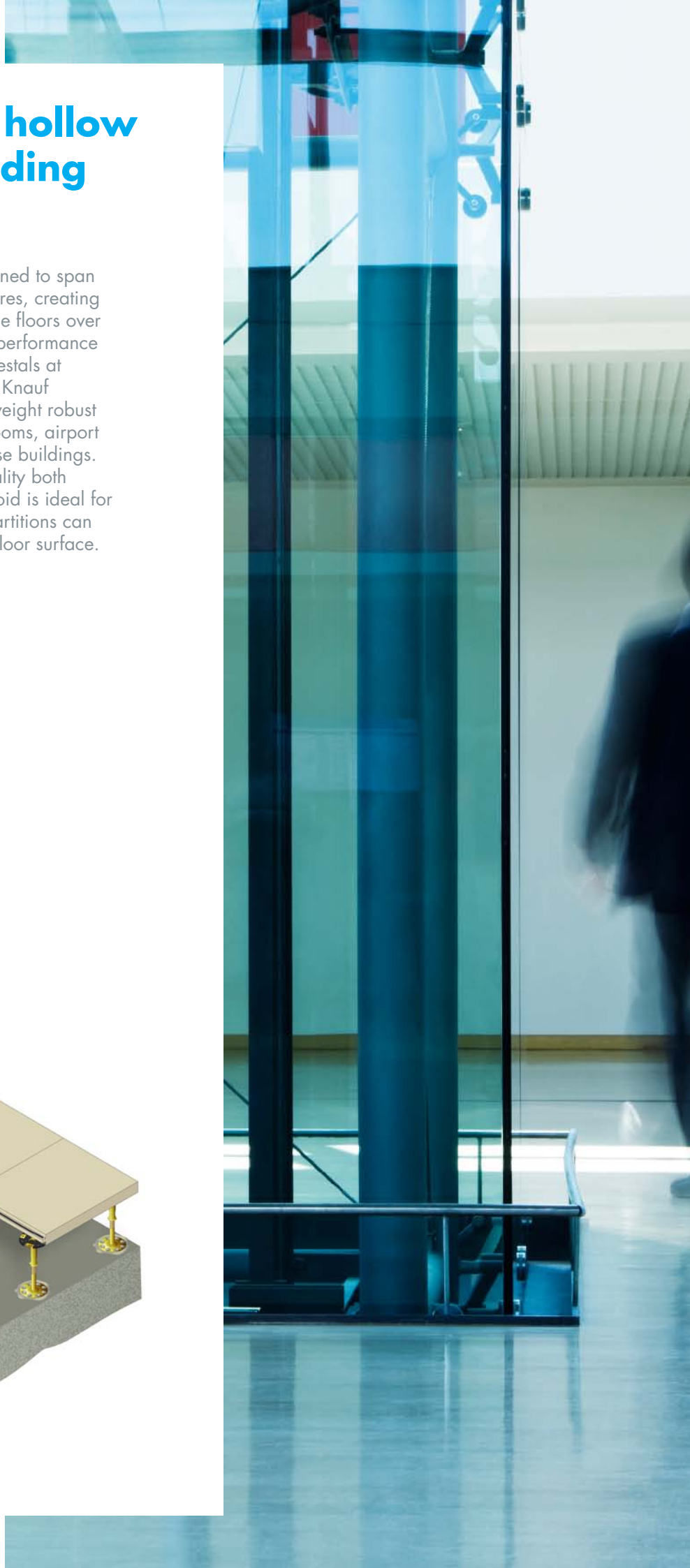
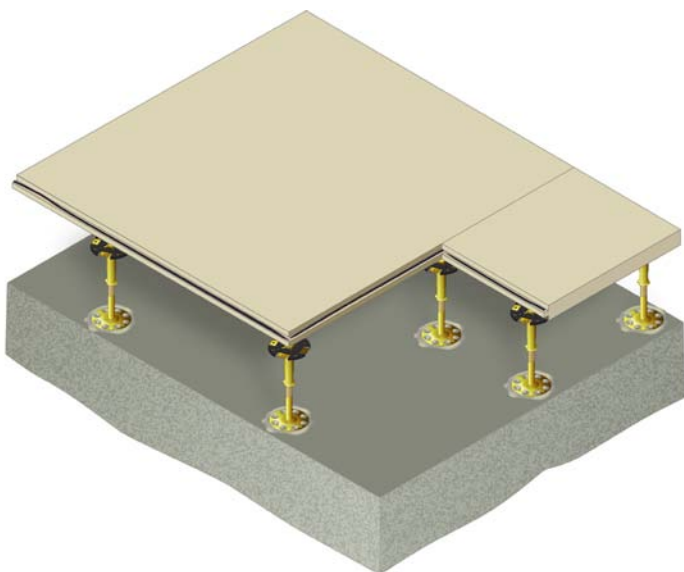



## Maximum acoustic performance over joists and battens

Knauf GIFAfloor panels are strong and versatile and can also be used to span joisted and battened floors. The high mass of Knauf GIFAfloor panels, when installed over acoustic batten or resilient layers, creates high acoustic performances with the feel of a solid floor underfoot. The excellent thermal conductivity of Knauf GIFAfloor panels ( $\lambda_R = 0.44 \text{ W/mK}$ ) also make them ideally suited to underfloor heating systems running between joists or over battens. The stability and strength of Knauf GIFAfloor is not just excellent across traditional solid timber and engineered timber joists but also steel sections and trapezoidal metal sheet. Knauf GIFAfloor panels can be cut and worked to create steps and slopes, suiting any floor design.

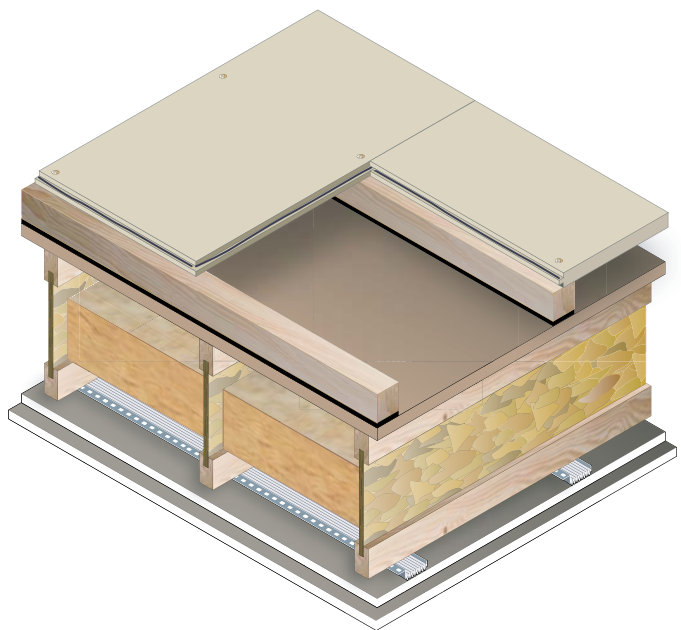

## Service void access that doesn't compromise your vision

Knauf GIFAfloor systems can be designed to incorporate access frames and access panels, providing an easy route to the service void below the floor. Knauf GIFAfloor access systems are available in 600mm x 600mm configurations as standard to suit most access requirements. However, bespoke sized access frames and panels can also be created to suit individual demands. Knauf GIFAfloor frames come with adjustable transition bars which provide a non-intrusive and robust edge to any floor finish, so that functionality need never be at the expense of aesthetics.





## The perfect substrate for the perfect finish

Floor finishes can be bonded directly to Knauf GIFAfloor panels, eliminating the need for expensive de-bonding layers. The structural gypsum fibre panels need only to be primed prior to application of the finished coating with appropriate flexible adhesives. Total design freedom is facilitated as Knauf GIFAfloor is the ideal substrate for carpets, laminates, timbers, stone, ceramic, porcelain and, when installed over an application of latex, vinyl floor coverings. However, Knauf GIFAfloor's strength and high dimensional stability mean that it is especially suited for stone and porcelain floor finishes, giving peace of mind in high-end project applications.

### KEY FACTS

#### **GIFAfloor creates a perfect substrate**

Suitable for almost any finish

Ideal for stone, ceramic, and porcelain floors

Minimal preparation required

No de-bonding layer needed

Extremely dimensionally stable



# Knauf GIFAfloor unlocks the potential of underfloor heating

Knauf GIFAfloor has low thermal resistance and a high thermal conductivity of  $\lambda_R = 0.44 \text{ W/mK}$ , making it ideal for underfloor heating systems. And Knauf GIFAfloor's versatility means it can incorporate underfloor heating systems in many different ways. Insulated trays can carry the heated water pipework beneath the Knauf GIFAfloor panels or pipes can be clipped into metal conductor plates running over joists and battens or along rows of pedestals. Knauf GIFAfloor can also be routed to take heating and cooling pipework directly, giving the flexibility of a wet screed solution but with a completely dry construction.

With no screed to dry, Knauf GIFAfloor underfloor heating solutions make installation and commissioning of the heating system faster and allow floor finishes to be laid within hours, not weeks.

Once installed, Knauf GIFAfloor enhances the efficiency of underfloor heating systems, giving reduced energy consumption and improving the system response time. So underfloor heating solutions with Knauf GIFAfloor are the sustainable choice for building owners, developers and occupiers alike.

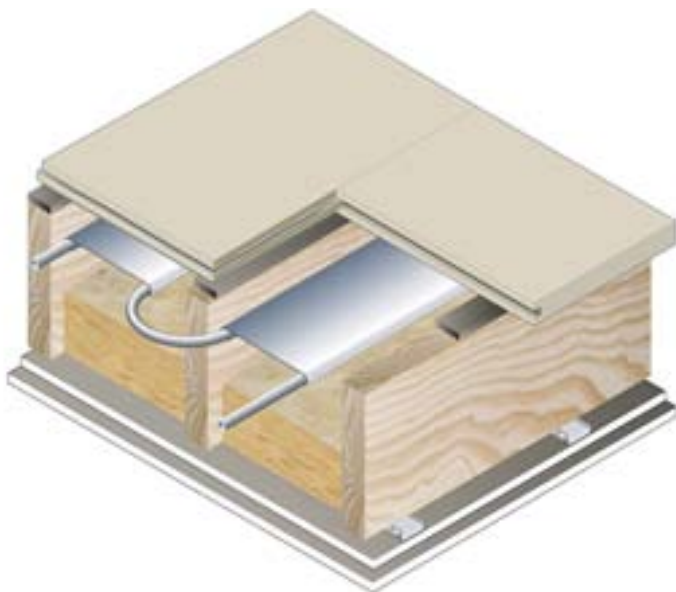



# GIFAfloor ticks all the environmental boxes

## Sustainable in manufacturing

- ✓ Knauf GIFAfloor panels have 50% recycled content
- ✓ Knauf Drywall has ISO14001 certification

## Sustainable in construction

- ✓ Scores two water management points in Code for Sustainable Homes
- ✓ Reduces cement content of building
- ✓ Reduces load on tower blocks, reducing foundation and steelwork requirements

## Sustainable in use

- ✓ Saves CO<sub>2</sub> emissions due to its efficiency with UFH system over timber or cement base floors
- ✓ Optimises benefit of air and ground source heat pumps

## Also available from Knauf Drywall

Knauf Brio range of dry floor screed panels for enhanced acoustic and UFH thermal efficiency.

# **KNAUF** DRYWALL

## **Customer Service**

UK Freephone: 0800 521 050

UK Freefax: 0800 521 205

Eire Tel: 01 4620739

Eire Fax: 01 4620745

Email: [cservice@knauf.co.uk](mailto:cservice@knauf.co.uk)

## **Technical Service**

UK Tel: 01795 416 259

Eire Tel: 01 4620739

Email: [technical@knauf.co.uk](mailto:technical@knauf.co.uk)

## **Literature**

UK Tel: 08700 613 700

Eire Tel: +44 8700 613 700

## **Website**

[www.knaufdrywall.co.uk](http://www.knaufdrywall.co.uk)

[www.knauf.ie](http://www.knauf.ie)

Knauf Drywall  
Kemsley Fields Business Park  
Sittingbourne  
Kent ME9 8SR

Knauf Drywall  
87 Broomhill Road  
Tallaght  
Dublin 24

## **Knauf Drywall Factory Locations**

Ridham Dock  
Sittingbourne  
Kent

Queens Road  
Immingham  
N.E. Lincolnshire



© Copyright Knauf Drywall 2012

The information given in this publication is believed to be current and accurate as at the date of publication, but no warranty, express or implied is given. Updates will not be automatically issued.



When you have finished with  
this document please recycle it



This document is printed  
on 80% recycled paper